

REVISIONS					
ZONE	ECN	REV.	DESCRIPTION	DATE	APP'D
		C	CHANGE INLET DESIGN	1/5/11	ILD

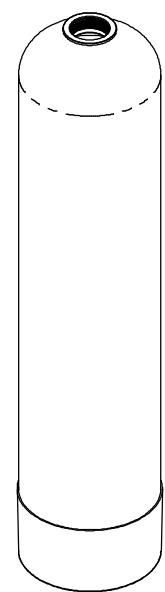
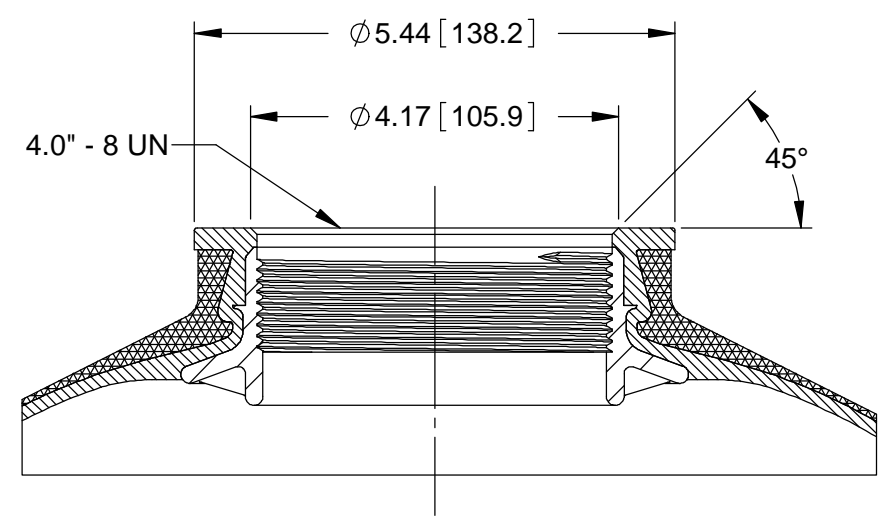
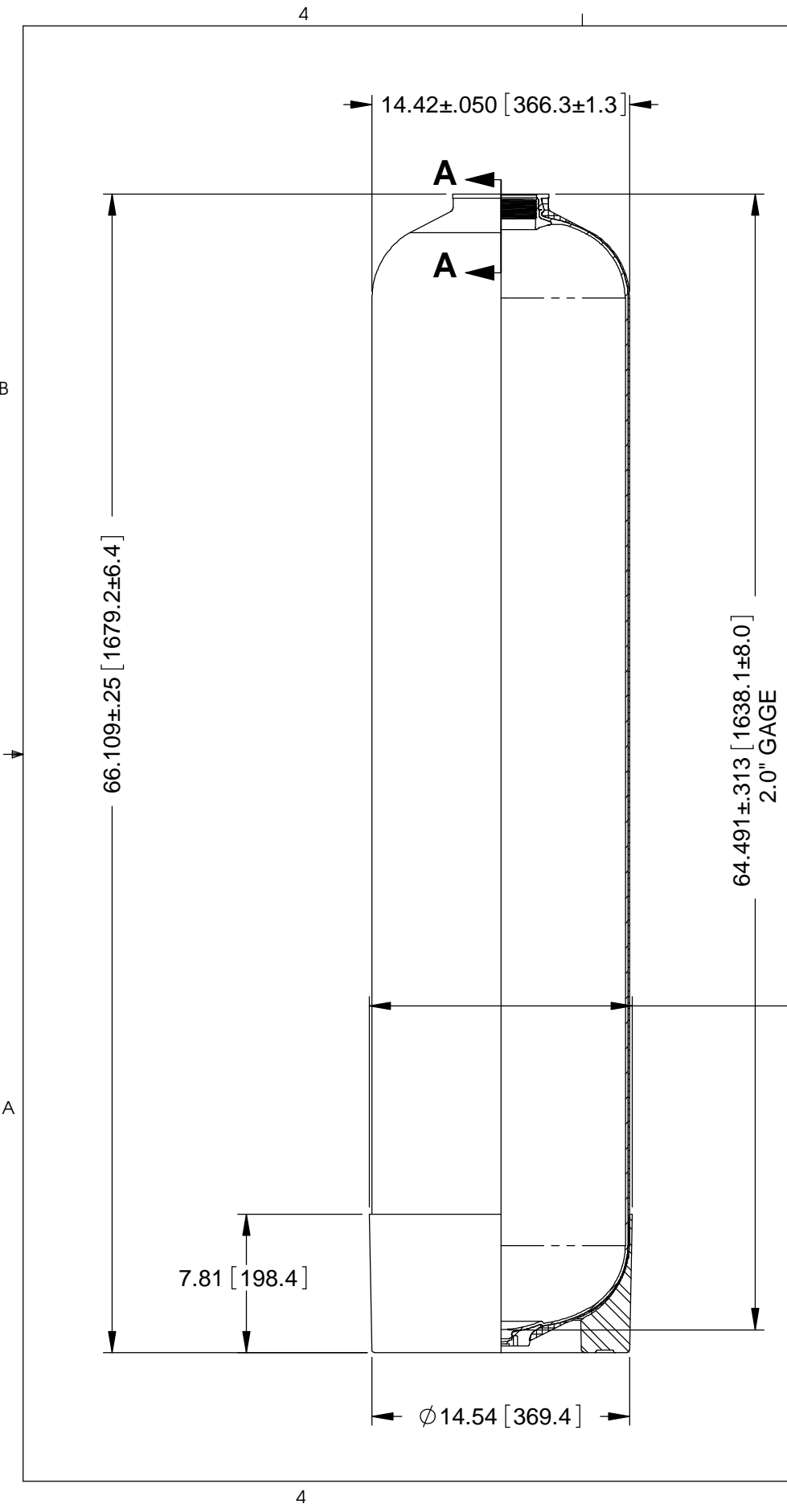

MAX OPERATING PRESSURE	150 psig	[1034 kPa]
MAX OPERATING TEMPERATURE	120 °F	[49 °C]
TANK VOLUME	38.0 gal	[143.8 L]
DOME VOLUME	1.7 gal	[6.4 L]
TANK WEIGHT WITH BASE	32.0 lb	[14.5 kg]

1. NOT SUITABLE FOR PNEUMATIC PRESSURE APPLICATIONS.
2. TANK ELONGATES UP TO .25 [6.4] AT MAXIMUM OPERATING PRESSURE. FLEXIBLE CONNECTIONS ARE RECOMMENDED TO PREVENT DAMAGE TO THE TANK OR PIPING.
3. TANK IS RATED FOR AN INTERNAL NEGATIVE PRESSURE OF 5.0 [127] OF Hg VACUUM. HIGHER VACUUM VALUES MUST BE PREVENTED WITH AN ADEQUATE VACUUM BREAKER
4. MINIMUM CLEARANCE OF 48.0 [1219.2] ON TOP REQUIRED FOR PIPING AND MANEUVERING.

LAST SAVED IN SMARTEAM:1/5/2011 12:29:35 PM

CRITICALITY SYMBOLS PER QPSP-001.2

□ LEVEL I    ■ LEVEL II    ■ LEVEL III

THIS DOCUMENT IS SOLELY THE PROPERTY OF PENTAIR WATER TREATMENT. REPRODUCTION, USE DISCLOSURE, OR TRANSMISSION OF THIS DOCUMENT OR DETAILS CONTAINED HEREIN, IN PART OR IN WHOLE, IS PROHIBITED WITHOUT THE WRITTEN CONSENT OF PENTAIR WATER TREATMENT ENGINEERING. THIS DOCUMENT AND ANY COPIES SHALL BE RETURNED TO PENTAIR WATER TREATMENT UPON WRITTEN REQUEST.

DO NOT SCALE DRAWING. DIMS. ARE IN INCHES [mm]  
 INTERPRET DIMS AND TOLERANCES PER ASME Y14.5M -1994  
 UNLESS OTHERWISE SPECIFIED:  
 CORNER FILLETS R.005-.020 [127-508]  
 TOLERANCES:  
 ANGLES : ± 1°  
 1 PLACE .X: ± .015 [0.38]  
 2 PLACE .XX: ± .01 [0.3]  
 3 PLACE .XXX: ± .005 [0.13]

THIS DRAWING MUST BE COMPARED TO THE ERP SYSTEM TO ENSURE CORRECT REVISION LEVEL PRIOR TO USE.

THIRD ANGLE PROJECTION		
APPROVALS	DATE	
DRAWN	ILD	5/7/08
CHECKED		
APPROVED	ILD	1/5/11

**Pentair Water**  
 Pentair Water Chardon  
 220 PARK DRIVE  
 CHARDON, OH 44024 USA

TITLE: **14X65 PG TANK w/ COMP BASE  
 4.0" TOP INLET**

SIZE: **B**    DWG NO.: **CHSK-5200**    REV: **C**

SCALE: 1:8    SOLIDWORKS FORMAT    SHEET 1 OF 1